

SECTION NO.
950-090

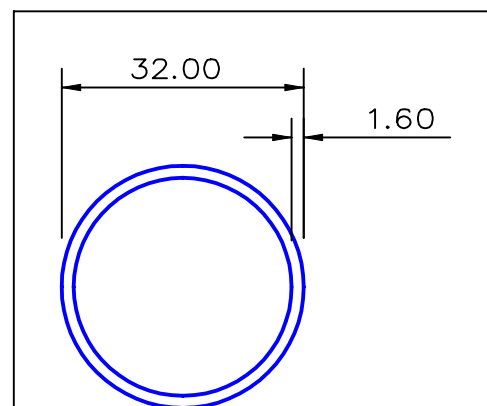

SECTION DATA:
 $I_{xx} = 17\,701 \text{ mm}^4$
 $I_{yy} = 17\,701 \text{ mm}^4$
 $\text{Theta} = 1.0^\circ$
 $\text{RadG}_x = 11. \text{ mm}$
 $\text{RadG}_y = 11. \text{ mm}$
 $X_{C_{\text{left}}} = 16.0 \text{ mm}$
 $X_{C_{\text{right}}} = 16.0 \text{ mm}$
 $Y_{C_{\text{top}}} = 16.0 \text{ mm}$
 $Y_{C_{\text{bot}}} = 16.0 \text{ mm}$
 $Z_{xx_{\text{top}}} = 1\,106 \text{ mm}^3$
 $Z_{xx_{\text{bot}}} = 1\,106 \text{ mm}^3$
 $Z_{yy_{\text{left}}} = 1\,106 \text{ mm}^3$
 $Z_{yy_{\text{right}}} = 1\,106 \text{ mm}^3$

0.40 RADIUS ON ALL OUTSIDE CORNERS
UNLESS OTHERWISE SPECIFIED

EXTRUDED FINISH : ARCHITECTURAL

				A		AREA	152.8	SQ MM	 G. James Extrusion Co. A.C.N 010 828 234 1082 KINGSFORD SMITH DRIVE, EAGLE FARM, QUEENSLAND, 4009 PO BOX 1376, EAGLE FARM BC, 4009 PHONE : (07) 3877 2833 FAX : (07) 3877 2890	CUSTOMER		G. JAMES EXTRUSION Co.		
						WEIGHT	0.414	KG M		CUSTOMER PART NAME		NO.		
						PERIMETER	191.0	MM		32.0 x 1.6 ROUND TUBE				
						ANOD PERIM	100.5	MM		SCALE		TOLERANCES IN ACCORDANCE WITH AS 1866-1986		
						PAIN PERIM	100.5	MM		1:1		APPLY UNLESS OTHERWISE SPECIFIED		
						C CIRCLE DIA	32.	MM		DRAWN		CHECK	DATE	DWG. NO.
						FACTOR	461.			JWC			06/04/87	950-090
						ALLOY	6063							
						TEMPER	T6							
NO	DATE	DR	REVISION											